



COST SHARE AGREEMENT
Between the
Eastern Montana and Dakotas District BLM,
Northern Cheyenne Agency BIA,
And the
Eastern Land Office Montana DNRC

This cost share agreement is between the agencies identified above, as negotiated for the following incident in accordance with the Montana Statewide Cooperative Fire Protection Agreement #L17FMA00001/17P00FM0001/17C00440901/17-FI-11015600-010 executed between the parties on (01/27/2017). The purpose of this agreement is to allocate financial responsibility as outlined in the Fire Decision Document and to describe the cost division.

General Incident Information:

Incident Name:	Tongue River Complex*		
Incident Start Date and Time:	July 6, 2017 01:00		
Origin:	BIA & BLM		
Township: 58	Range: 41E	Section: 34	
Estimated Size: 33,000 acres	Acres at the time of this agreement: 32,965 acres		
Incident Cause:	Lightning		

Incident Numbers by Protection Agency:

Agency	Incident #	Accounting Code
BIA	MT-MCD-000163	K4YU
BLM	MT-MCD-000163	K4YU
MT DNRC	MT-MCD-000163	747003

Cost Share Period: This agreement becomes effective on the date indicated below and will remain in effect until amended or terminated.

State date/time: **07/06/2017 at 01:00**

End date/time: **End of Incident**

***The Tongue River Complex includes the Witten (K4P2) and Lee Creek fires (K4EZ).**

Other conditions relative to this agreement:

1. Costs incurred by cooperators not engaged with the host agency or IMT in the fire suppression activities will not be included as a part of this cost share agreement.
2. Responsibility for tort claim costs will not be a part of this agreement. Responsibility for these costs will be determined outside this agreement.
3. Costs for accountable, sensitive, and durable property purchased by each agency will be charged directly to that agency and will not be shared.
4. Non-suppression rehabilitation costs are the responsibility of the jurisdictional agency and will not be shared.
5. Each agency will bill for their costs as outlined in the MT Cooperative Fire Agreement billing procedures.



Cost Share Methodology:

The percentage of acres burned methodology was chosen for this complex of fires, because the values at risk were the same for all agencies involved. **See the attached map for incident acreage (ignore option 2 on the map, as it was an error) and for the final IMT e-ISuite estimated costs.**

Final Agency Apportionment:

1. Federal Share:

a.	USFS	%
b.	BLM	48.45 %
c.	FWS	%
d.	NPS	%
e.	BIA	15.16 %

2. State Share :

a.	MT	36.39 %
b.	ID	%
c.	ND	%
d.	other	%

Principal Contacts:

The following personnel are the principal contacts:

Title:	Name:	Agency:
Agency Administrator	Chris Pileski	MT DNRC
Agency Administrator	Mike Addy	BIA
Agency Administrator	Diane Friez	BLM
Agency Representative		
Incident Business Advisor(s)	Sarah J. Lee Amanda Boatright	BLM BIA
Incident Commander(s)	Mike Almas	USFS
Other IMT members as appropriate		



Signatures of Authorized Personnel & Attachments:

This agreement and the apportionment described are our best judgments of fair and equitable agency cost responsibilities.

List and include appropriate attachments (such as I-Suite reports, Aircraft Use Reports, map, etc.):

Original Agreement: #1

Supplemental Agreement: Number _____ Supersedes Agreement # _____ Dated _____

Agency Name: **Eastern Land Office, Montana DNRC**
Address: **P.O. Box 1794**
City, State Zip: **Miles City, MT 59301**

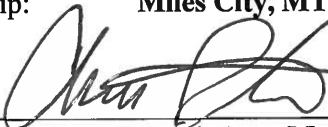
Signature:  Date: 7/31/17
Chris Pileski, Area Manager

Agency Name: **Northern Cheyenne Agency, BIA**
Address: **P.O. Box 40**
City, State Zip: **Lame Deer, MT 59043**

Signature: _____ Date: _____
Mike Addy, Agency Superintendent

Agency Name: **Eastern Montana/Dakotas District, BLM**
Address: **111 Garryowen Road**
City, State Zip: **Miles City, MT 59301**

Signature:  Date: 8/1/2017
for **Diane Friez, District Manager**



Signatures of Authorized Personnel & Attachments:

This agreement and the apportionment described are our best judgments of fair and equitable agency cost responsibilities.

List and include appropriate attachments (such as I-Suite reports, Aircraft Use Reports, map, etc.):

Original Agreement: #1

Supplemental Agreement: Number _____ Supersedes Agreement # _____ Dated _____

Agency Name: **Eastern Land Office, Montana DNRC**
Address: **P.O. Box 1794**
City, State Zip: **Miles City, MT 59301**

Signature: _____ Date: _____
Chris Pileski, Area Manager

Agency Name: **Northern Cheyenne Agency, BIA**
Address: **P.O. Box 40**
City, State Zip: **Lame Deer, MT 59043**

Signature: *Mike Addy* Date: 8-2-17
Mike Addy, Agency Superintendent

Agency Name: **Eastern Montana/Dakotas District, BLM**
Address: **111 Garryowen Road**
City, State Zip: **Miles City, MT 59301**

Signature: _____ Date: _____
Diane Friez, District Manager

OWNERSHIP PERCENTAGE MAP

TONGUE RIVER COMPLEX

WITTEN FIRE
28,957 ACRES

LEE CREEK FIRE
4008 ACRES

MT-MCD-000163
JULY 15, 2017

-  Fire Perimeter
-  BLM & Tribal Lands
-  Private Lands
-  State of Montana
-  US BLM
-  US Forest Service

ANDROID INSTRUCTIONS
open PDF Maps, click on + to add map, then click the orange download button, click on map QR code icon at top right of screen to access camera, scan QR code, click on desired daily folder to access maps, click on desired map to download



IPHONE INSTRUCTIONS
open PDF Maps, click on + to add map, click on map QR code icon at top right of screen to access camera, scan QR code, click on desired daily folder to access maps, click on desired map to download



NAD 1983
0 0.5 1 2
MILES



Created by CDAL/JY 7/14/2017 11:23:24 AM

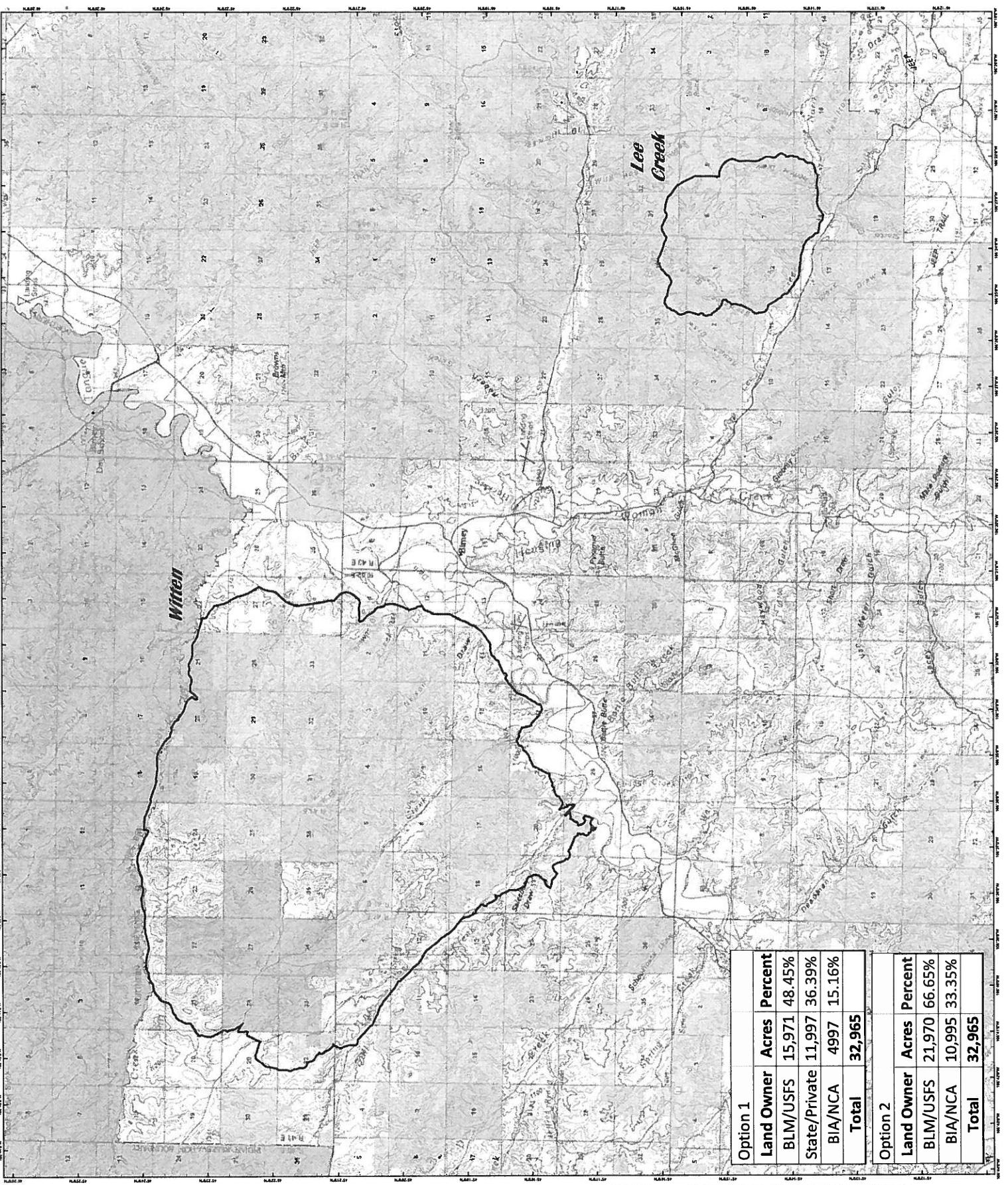

Option 1			
Land Owner	Acres	Percent	
BLM/USFS	15,971	48.45%	
State/Private	11,997	36.39%	
BIA/NCA	4997	15.16%	
Total	32,965		

Option 2			
Land Owner	Acres	Percent	
BLM/USFS	21,970	66.65%	
BIA/NCA	10,995	33.35%	
Total	32,965		

Incident Summary of Current Day - 07/16/2017

Incident: TONGUE RIVER COMPLEX (US-MT-MCD-000163)

Group By Incident

	Current Day	Cumulative
AIRTANKER	0	168,275
FIXED WING AIR	0	33,982
HEAVY HELI	0	259,958
LIGHT HELI	0	68,639
AIRCRAFT TOTAL	0	530,854
HANDCREW-TYPE 1	0	291,558
HANDCREW-TYPE 2	0	77,325
HANDCREW-TYPE 2 1A	11,284	106,633
CREWS TOTAL	11,284	475,516
DOZERS	2,324	48,330
ENGINES	3,895	280,598
OTHER EQUIPMENT	0	250
EQUIPMENT TOTAL	6,219	329,178
DIRECT PERSONNEL	9,661	107,335
LINE PERSONNEL TOTAL	9,661	107,335
DIRECT TOTAL	27,164	1,442,883
INDIRECT PERSONNEL	34,995	354,564
CAMP PERSONNEL TOTAL	34,995	354,564
BUSES	1,831	8,175
CAMP CREW	12,799	99,339
CATERER	23,790	192,159
FACILITIES/OTHER	21,016	100,998
MOB/DEMOB	32,550	261,350
OTHER EQUIPMENT	18,290	128,401
SHOWERS	0	16,715
SUPPLIES	1,731	97,147
VEHICLES	915	7,461
WATER TENDERS	0	44,954
CAMP SUPPORT TOTAL	112,922	956,699
INDIRECT TOTAL	147,917	1,311,263
GRAND TOTAL	175,081	2,754,146